

Laminating Pouches

APEX LAMINATING POUCH LIGHT A3/A4 GLOSS

APEX Laminating Pouches

Features:

- Glossy finish
- Protects and enhances the image of documents
- Highest quality in lamination
- Occasional use
- Apex Light pouches are designed for use at 80 Micron setting
- A3 format 303 x 426 mm, A4 format 216 x 303 mm
- Pack of 100
- Compatible with all laminator brands

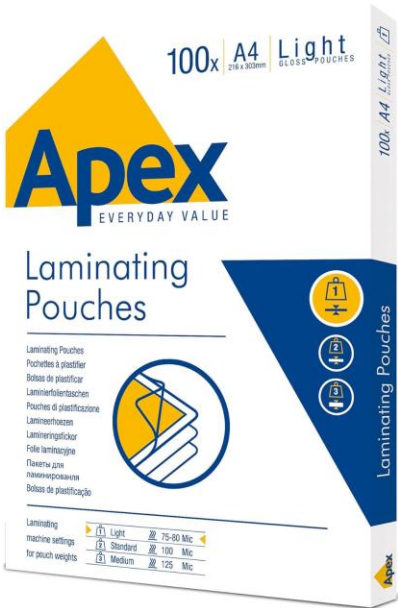

Specifications

Segment	APEX Laminating Pouches	
Size	A3 / A4	
Pouch Thickness (mic)	Light	
Pouch Thickness (mm)	-	
Finish	Clear	
Feature / Specialty	-	
Best Used For	Notices – Photos	
Main Materials	PET - EVA	
Quantity per Pack	100	
Quantity per Outer	A3 - 5	A4 - 10
Country of Origin	China	

A4	216x303mm	1	Light
A3	303x426mm	1	Light
A4	216x303mm	2	Standard
A3	303x426mm	2	Standard
A4	216x303mm	3	Medium
A3	303x426mm	3	Medium



APEX LIGHT A3 – 100pk	6001901	UPC: 043859584840	SCS: 50043859584845
APEX LIGHT A4 – 100pk	6003201	UPC: 043859584857	SCS: 50043859584852

Laminating Pouches

APEX LAMINATING POUCH LIGHT A3/A4 GLOSS

APEX Laminating Pouches

Recyclability:

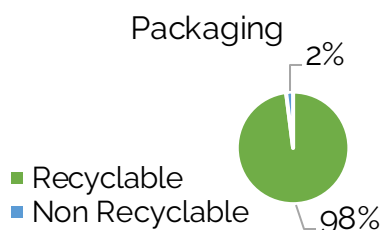

Packaging Recyclability
Percentage of the packaging by weight that can be sent for recycling

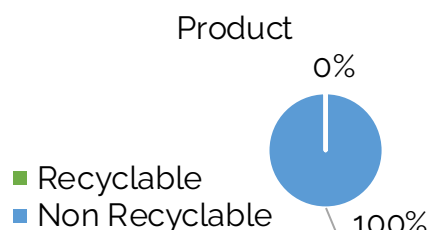

Product Recyclability
Percentage of the product by weight that can easily be separated and sent for recycling

Other information:

Support: For product related questions or further information, our dedicated Customer Service team can be reached at our freephone number 00800 1810 1810 for any questions.

After Sales Support:

- Repairable: N/A
- Availability of Spare Parts: N/A
- Returnable: Yes, as per Fellowes Trading Conditions

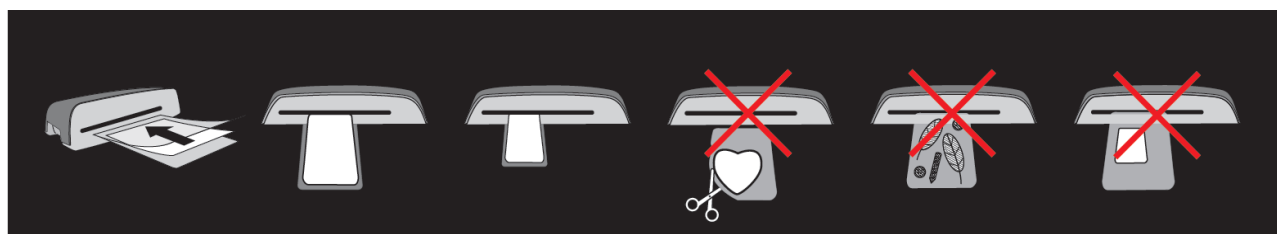

- **DO** ensure the document is centred against the sealed edge.
- **DO** use pouches designed for use at the appropriate settings
- **DO** ensure the pouch enters the machine sealed edge first. Use the entry markings as a guide
- **DO NOT** trim the pouch before laminating
- **DO NOT** laminate sharp or metal objects
- **DO NOT** use an incorrect pouch size for the document